

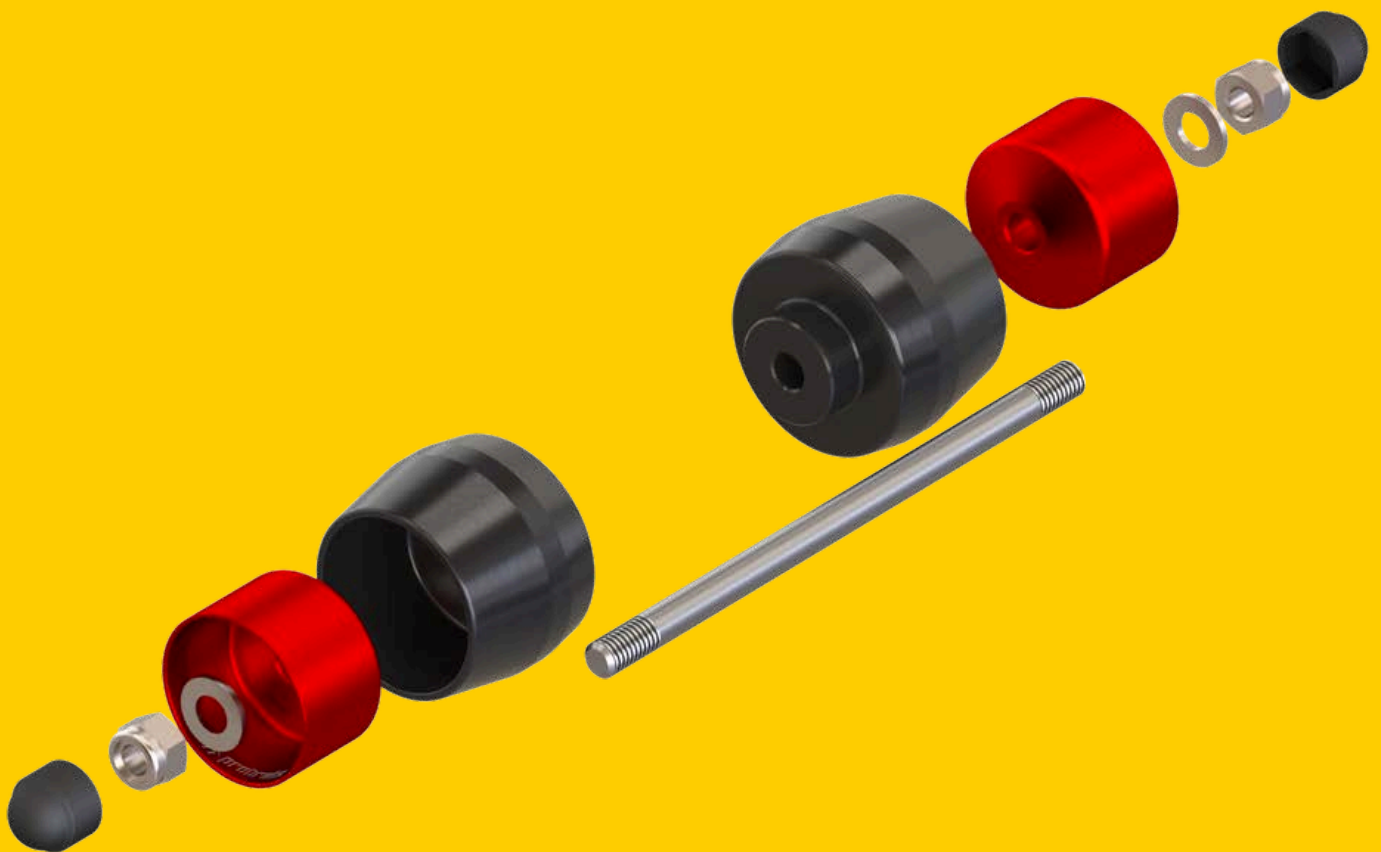

# *Installation Manual*

## *Axle Sliders*



**probrake.de**

### General Safety Instructions for Installing Axle Sliders



Installing axle sliders pads requires technical understanding and solid mechanical skills. Incorrect installation can lead to serious accidents and damage to the motorcycle. Please observe the following safety instructions.

#### Before Installation

- Tools: Use only recommended, suitable tools.
- Know-how: Perform the installation only if you have sufficient knowledge.
- Questions or issues: Contact a workshop with appropriately qualified personnel.
- Stability: Secure the motorcycle stably on a paddock/maintenance stand.
- Read first: Read these instructions carefully and completely before installation.

#### During Installation

- Torque: Tighten screws to the specified torque values.
- Inspect parts: Check all components for damage before installation.
- No force: Work precisely and do not force components.

#### After Installation

- Safety check: Verify the secure fit of all screws and components.
- Test ride: Perform a careful test ride and watch for irregularities.

#### General Notes

- Use only original or approved replacement parts.
- Perform regular checks for secure fit and wear.
- Damaged parts must be replaced immediately; otherwise proper function cannot be guaranteed. Any manipulation such as welding, soldering, bending, or drilling the pads is prohibited.
- probrake GmbH assumes no liability or warranty for any damage resulting from combinations with accessories not tested by probrake, from improper installation, or from insufficient maintenance.



#### General Operating Permit

- The axel pads are registration-free.
- No ABE (General Operating Permit) or parts certificate is required.
- Outside Germany, different legal regulations may apply.

### Scope of Delivery Axle Sliders SPIKE (per side)

1. Absorber pad
2. Colored anodized aluminum inlay
3. Mounting material
4. Mounting kit (vehicle-specific, see separate enclosed installation guide)

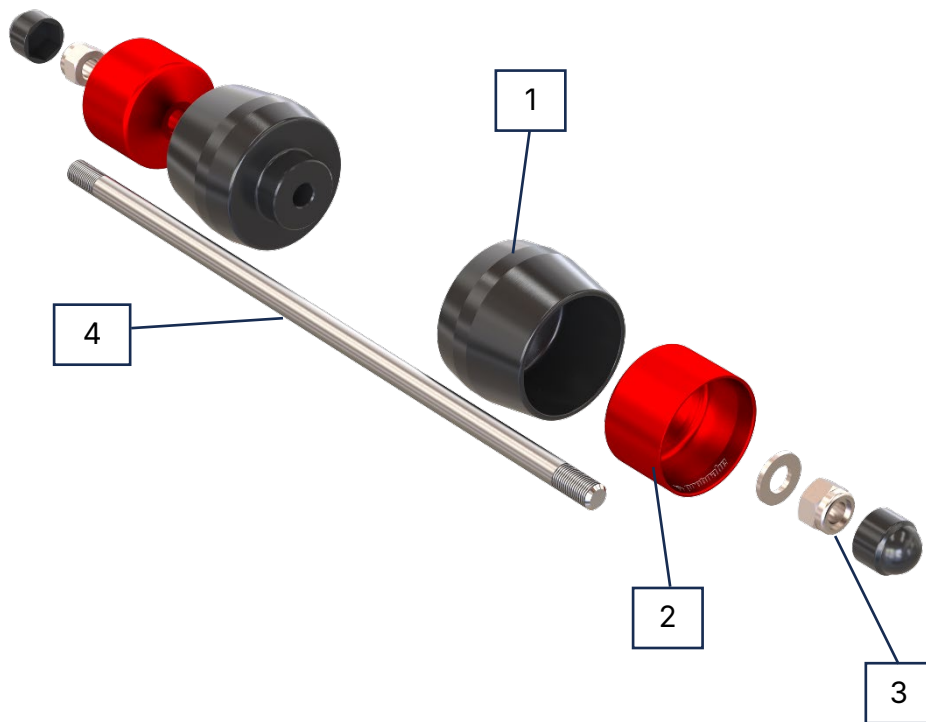

### General Installation Notes – Axle Sliders

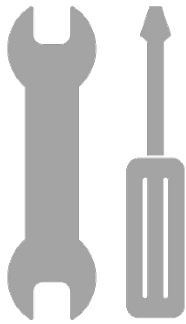

#### Preparation

- Park the motorcycle securely.
- Lay out tools within easy reach.

#### Installing the probrake Axle Sliders

- Insert the threaded rod [4] into the respective axle mount on the motorcycle
- Place the absorber pads [1] onto the threaded rod [4] with the opening facing outwards
- Push the colored aluminum inlays [2] into the absorber pads [1] on the threaded rod [4]
- Screw the pads and inlay [1+2] onto the threaded rod [4] using the washers and nuts [3]
- Check that the pads are positioned at equal distances from each other.
- Secure the two nuts with threadlocker.
- Observe the torque specifications
- Observe the conditions of the operating license
- After the test drive, check that all screws are
- Press the cover caps onto the lock nuts

#### Special Notes for Installation

- Depending on the vehicle model, vehicle-specific attachments are included which must be fitted according to the respective vehicle design.

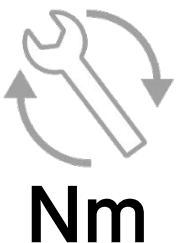

#### If the vehicle manufacturer does not specify otherwise, observe the following torques:

- M5 screws must be tightened to **6 Nm**
- M6 screws must be tightened to **10 Nm**
- M8 screws must be tightened to **25 Nm**
- M10 screws must be tightened to **40 Nm**
- M12 screws must be tightened to **70 Nm**
- All screw connections must be secured with medium-strength threadlocker (exception: when using self-locking nuts).

# Here are some more probake quality products

## STEEL BRAIDED HOSES



## FOOTRESTS



## BRAKE & CLUTCH LEVER



## CRASH PADS & SAFETY



## HANDLEBARS



## BRAKE DISC & BRAKE PADS



## ACCESSORIES & ATTACHMENT



## STEEL BRAIDED KITS CARS



probrake GmbH  
Fritz-Schieler-Str. 3  
D-79331 Teningen

**probrake.de**

info@probrake.de

